

ALUMNI CLUB
BUILDING

MAHMUD HALLAB

ALUMNI CLUB

BUILDING.

MEMBER HALL

332

UNDER THE SUPERVISION OF
PROFESSOR H. H. HARRIS

AND THE COOPERATION OF THE
FACULTY

ALONG THESE COURSES

1917

Epsm 52

MEMORANDUM

A L U M N I C L U B

B U I L D I N G

By

M A H M U D H A L L A B

B. S. C. E

U N D E R T H E T U T E R S H I P O F

P R O F E S S O R N . M A N A S S E H

A N D T H E C O O P E R A T I O N O F T H E

P R E S E N T

A L U M N I T E N N I S C O M M I T T E E

- 1947 -

INTRODUCTION

Our country is on the treashold of a new era; it needs men socially, intellectually and politically fit to lead it along the right path. Undoubtedly, the elite of honest and sincere men (A.U.B. Graduates) are the only persons who can lead it to the place it occupied centuries ago.

In the last 25 years, our graduates worked independently to raise our standards; but it seemed that their efforts, being uncorrelated, were not giving the result they ought to have given; these efforts had to be coordinated in such a way as to be sure of a more effective and prolonged action.

That is why in the year the Alumni Association came into being. However, owing to the circumstances in which it lived, the Alumni Association could not do much, either in the ^{Political} or in the intellectual and social fields. Yet inspite of all difficulties, the Alumni Association could build up the present Alumni Tennis Club as a branch of its activities, also it could give scholarships to some students of the A.U.B.

In the year 1943, feeling that the circumstances were favorable (owing to the changes in the political life of the Arab World), the Alumni Association decided to act more energetically.

Finding itself in need of a place which would be a center where the Alumni, dispersed all over the Arab World, could meet, it discussed the possibility of founding a club.

In this club, members could meet to do their share in the social, intellectual, and political uplift of their fellowmen.

The club is necessary for the Alumni from the social point of view; because after graduating, the friendship among students would soon go into oblivion, were it not revived by frequent meetings in

a place where every member would be reminded of the days that made such friendship possible. Also the life the club provides will refine, not only its members, but also all the community. The lectures and discussions which will take place in the club will bring us into close contact with Arab and foreign personalities. The social standard too of all the community will be raised. And last but not least, the sportive life it provides will develop physically fit bodies, which are a necessary asset for the mentally fit men, destined to become the leaders of the country.

Intellectually, when the Alumni have a club where to meet, they can invite their fellow citizen to lectures (given either by members or by competent people), or to discussions regarding the daily problems presented by our modern complicated way of life.

A club is meant, also, to meet all the desires of its members. Besides the various kinds of games and sports, a member likes to have a place where he can have some mental relaxation in the proper environment. Thus a club, provided with a library, is an intellectual necessity.

The A.U.B. is not only the source of friendship among the Alumni, it is also the place where mutual understanding takes place among men, not having the same identity card, but fighting to reach one and only one goal, the unity of the Arab world.

A place for these enthusiastic and mutually understood young men and women to discuss political ideas seems to be necessary, especially in these days. They should enter the political field and be its leaders instead of standing, united, on the margin of life. ??

So for these three reasons, social, intellectual, and political, the Alumni decided to have a building under the name of THE A.U.B. ALUMNI CLUB.

Last year they asked Mr. F. Shehadi to work on the club as his Thesis; but following his advice, they changed the place to another one near the sea shore. Another design seemed then to be necessary. So they charged me, through Mr. Shehadi, to take the Alumni Club as my Thesis.

After carefull studies with the Alumni Tennis Club and Professor Manasseh, these plans were laid out to meet the requirements of the Club from every point of wiew.

*Introduction
too "flowery"*

As the lot we choose is ... it would have been better had it been on the other side of ... the place of the second football field near the swimming pool so that members could see it ... with the location we have, the members have to cross the field to reach the swimming pool.

Regarding all other considerations, I think the lot chosen is good.

MAIN IDEA

The main idea is to have a Salon, dining room, and kitchen for members who wish to spend the night in the club, a living room and a bar. An auditorium was not asked for because the members can use the hall when needed.

REQUIREMENTS

... was given to the Alumni Tennis Club as follows:
A Salon
A Dining Room
A Kitchen
A Living Room
A Bar

LOCATION OF BUILDING

As I said before, Mr. F. Shehadi proposed to have the site near the sea. So they followed his advise and could secure the lot containing the mill and the hydraulic laboratory and which is limited by the Dean's house in the south, the Athletic football field in the West, the Corniche and the sea in the North and private properties in the East.

The high tide of activities in the Club will be at any time during the year; because in Summer we have the swimming season, in Winter the skiing season and the season of meetings and works; in Spring and Autumn trips are held. The Club is supposed to be the center of all these activities.

So the Lot as chosen is good, but it would have been better, had it been on the other side of the field, in the place of the second football field near the swimming place, so that members could use it. Now with the location we have, the members have to cross the field to reach the swimming place

Regarding all other considerations, I think the Lot chosen is good.

MAIN IDEA

The main idea is to have a Salon, Sitting rooms, Bed rooms for members who wish to spend the night in the club, a dining room and a Bar. An Auditorium was not asked for because the members can use West Hall when needed.

REQUIREMENTS

A set of requirements was given by the Alumni Tennis Club as follows

A Covered Tennis Court.

A Salon.

A Dining Room.
Sitting Rooms.
A Bar.
A Library.
Offices.
Toilet Rooms (men and women).
Card Rooms.
Showers and Lockers (men and women).
Bed Rooms.
Different kinds of Store Rooms.
A Kitchen
Servants' Quarters.
Game Rooms
 Bowling.
 Skating.
 Ping Pong.
 Billiards.
 Badminton.
Terraces.
Dancing Places.

DESIGN

This set of requirements was divided into different parts and located according to the use to which they are being put. Here follow the above mentioned requirements listed according to the floors in which they have been placed.

Basement

Bowling Alleys.
A Skating Ring.

Ground Floor

A Covered Tennis Court with a Grandstand.

Two Offices.

A Private Office.

Showers and Lockers (men and women).

A Dressing Room. (women)

A Ping Pong Room.

A Billiards Room.

A Big Vestibule.

A Kitchen.

A Food Store.

A Cold Room.

A Tennis Store Room.

A Fuel Store.

A Boilers Room.

And The Servants' Quarters. (men and women).

First Floor.

A Lounge.

A Salon.

A Dining Room.

A Committee Room.

A Sitting Room.

A Card Room.

A Library.

A Kitchenette and a Pantry.

A Bar.

Toilet Rooms. (men and women)

Terraces.

Second Floor.

Nine Sleeping Rooms.

A Card Room.

A Badminton Court.

A Ping Pong Room.

Third Floor.

A Store Room.

Covered Tennis Court Roof as a Big Dancing Place.

Before describing every floor with its partitioning, I should like to say something about the Club as a whole.

To add to the beautiful views offered by the sea, the 40 m. corniche with its green strips in its center, the villages on the slope of the mountains, a little garden 10 m. wide is provided for in front of the building, between the property line and the building itself. This garden will be on the same level as the corniche itself. On the eastern and southern sides, the building is flanked by a 6m. drive, with a 2% slope, which will lead to a parking space and to the store rooms. The drive is bordered on both sides by one meter wide side walks.

Also the Club is provided with four open Tennis Courts which are on a level 220 cm. higher than the level of the Corniche, and on the same level as the football field. These Tennis Courts are provided with a grandstand which can hold from 180 to 225 persons, maximum, for every two courts. These Courts can be reached either from the football field or from behind the Club.

One can notice, while studying these plans, that the Club can be divided into 3 main parts; the game rooms (in the ground floor and basement), the reception quarters (in the first floor), and the sleeping accommodations (in the second floor). Taking each part alone, I should like to say few words about it, the way it is divided into different units, and the units themselves.

I have chosen the Bowling Alleys and the Skating Ring in the Basement because they are noisy games.

The Bowling Room has three Alleys and a seating space which can hold about 30 to 40 persons. It is situated directly below the grandstand of the covered Tennis Court. It is on the same level as the garden in front of the building, and it has got a clear height of 240 cm. which I think, is quite sufficient.

The Alleys (section of which is shown in fig. 1 page 9) are of wood, resting on sand so that to lessen the noise coming from the rolling ball. To lessen the bumping of the ball against the wall at the end of the Alleys, a curtain wall coated with a layer of elastic materials is provided for as shown in fig. 2 page 10.

The Skating Ring has got also 240 cm. clear height but its floor is lower than the garden by 110 cm. I dont know if the height is sufficient or not, because I could not find a standard for it, but if it needs to be higher, the only possible ^{way} is to lower the floor.

Coming to the Ground Floor, we see that it has two main entrances with four secondary ones.

Three circular steps, leading to a large vestibule through doors made out of wood, iron and glass, as shown in fig. 3 (page 11) ,form the main Entrance. The Vestibule is a very large one and leads to the different parts of the Club. It is ornamented with flower and green plants. Statues, tableaux and other decorations will give a very good effect.

The other main entrance is from the A.U.B. grounds; few steps lead to a landing where one can reach either the ground floor or the first floor by descending or ascending, respectively, short flight of stairs. The door of this entrance and of the other auxiliary entrances are made of wood and glass with folding iron gates (as shown in fig. 4 page 12)

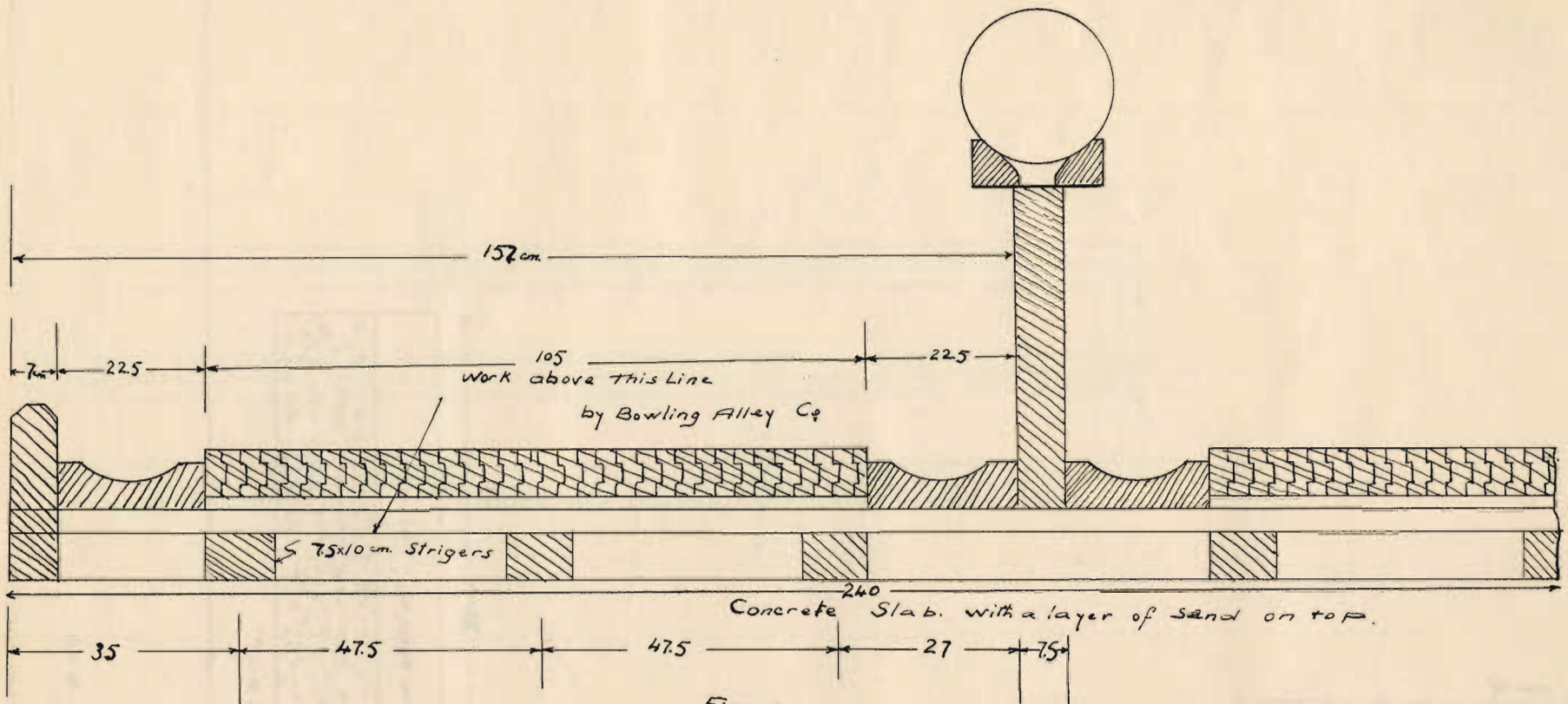

Fig. 1

Section of half the Alleys

Scale 1-10

20-5-46

Mahmud Hallab

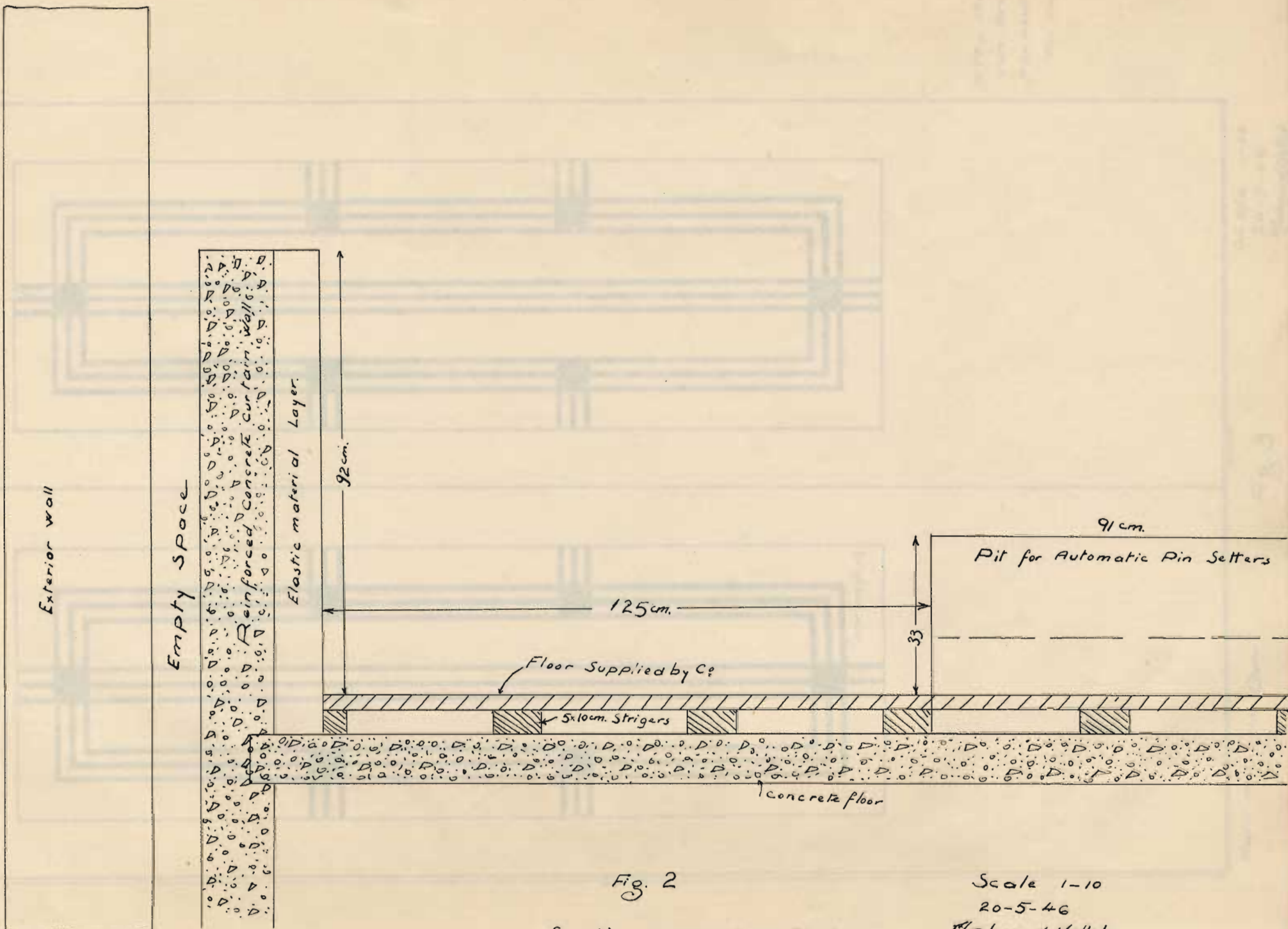
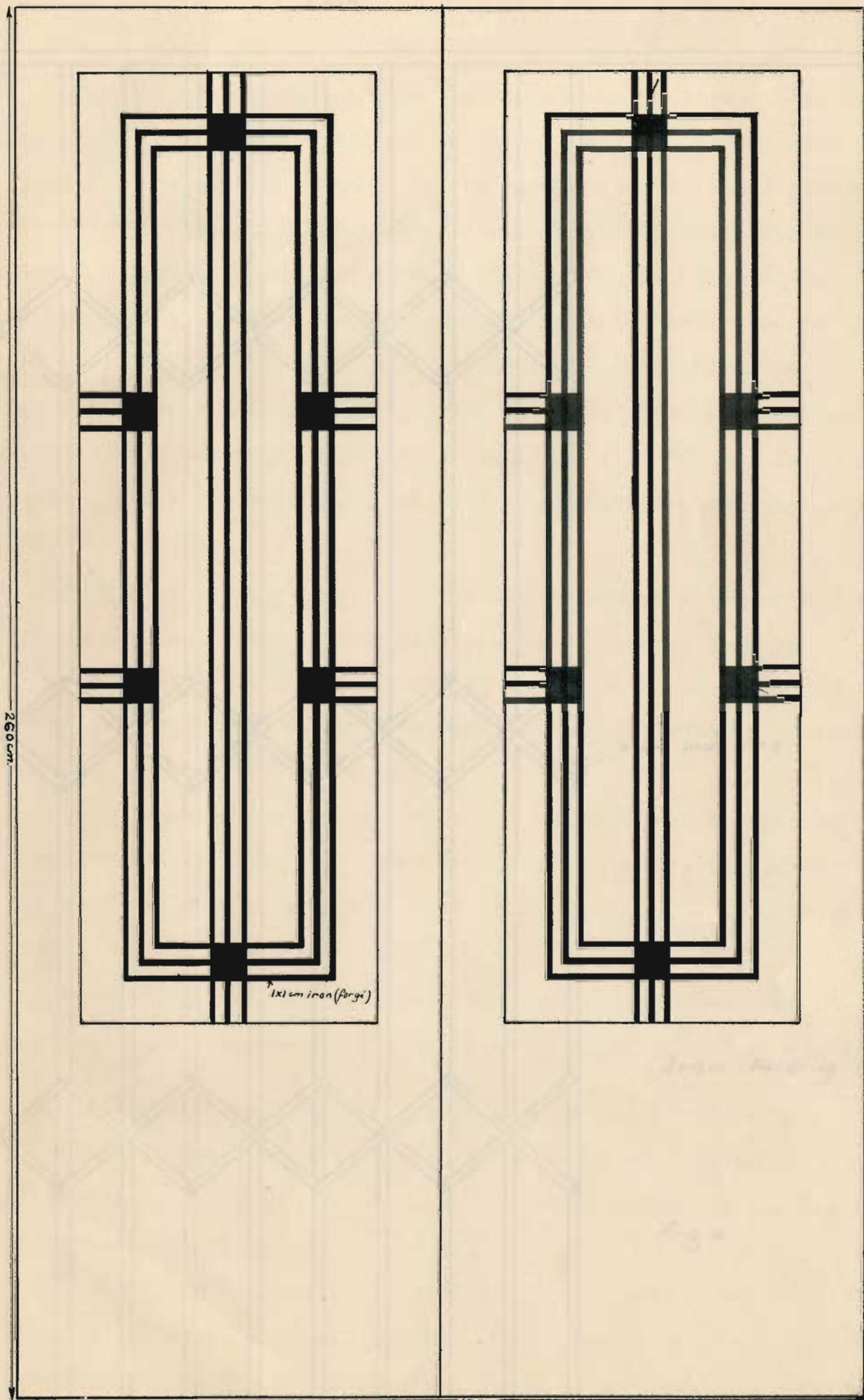

Fig. 2
Section showing Curtain
wall as Noise preventive.

Scale 1-10
20-5-46
Mahmud Hallet



260cm

1x1 cm iron (forgé)

160cm

Main Entrance Door

Fig. 3

Scale 1-10
20-5-46
Mahmud Helleb

A thin sheet of
iron preserve
the wood of
the door.

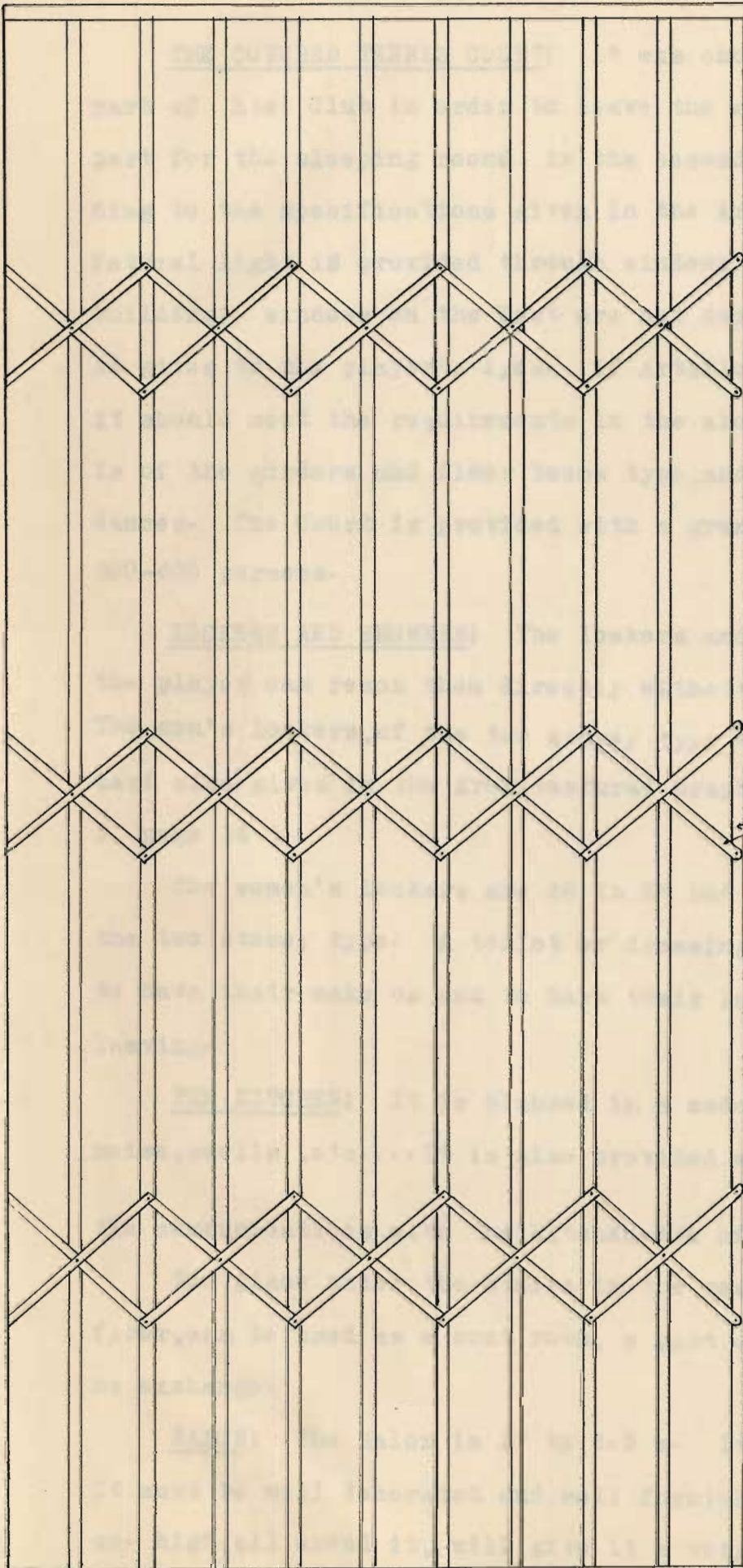

2 cm wide bars

Iron Folding Gate

Fig. 4

Scale 1-10
20-5-46

Mahmud Halla

THE COVERED TENNIS COURT; It was chosen to occupy the eastern part of the Club in order to leave the western and the south-western part for the sleeping rooms in the second floor. It is planned according to the specifications given in the Architectural Graphic Standards. Natural light is provided through windows on the north and south of the building; windows on the East are not desired because of the bad effect it gives to the player's eyes. If Artificial lighting is to be used, it should meet the requirements in the above mentioned book. The roof is of the girders and floor beams type, and will be used for big moonlight dances. The Court is provided with a grandstand which can hold about 300-400 persons.

LOCKERS AND SHOWERS; The lockers and showers are so situated that the player can reach them directly without passing through the vestibule. The men's lockers, of the two storey type, are 62 in N°-having the standard size given in the Architectural Graphic Standards (as shown in fig. 5 page 14).

The women's lockers are 26 in N° but they can be doubled if we use the two storey type. A toilet or dressing room is provided for ladies to have their make up and to have their last glance at the mirror before leaving.

THE KITCHEN; It is planned in a modern way in order not to have noise, smells, etc.... It is also provided with an elevator to facilitate the communications with the kitchenette of the Dining Room.

The place under the stairs in the vestibule, leading to the first floor, can be used as a coat room, a part of it can be used as a telephone exchange.

SALON; The Salon is 17 by 8.9 m. It can hold about 175 persons. It must be well decorated and well furnished. Strips of ARIDA stone 90 cm. high, all around it, will give it a very good appearance. Also a belt

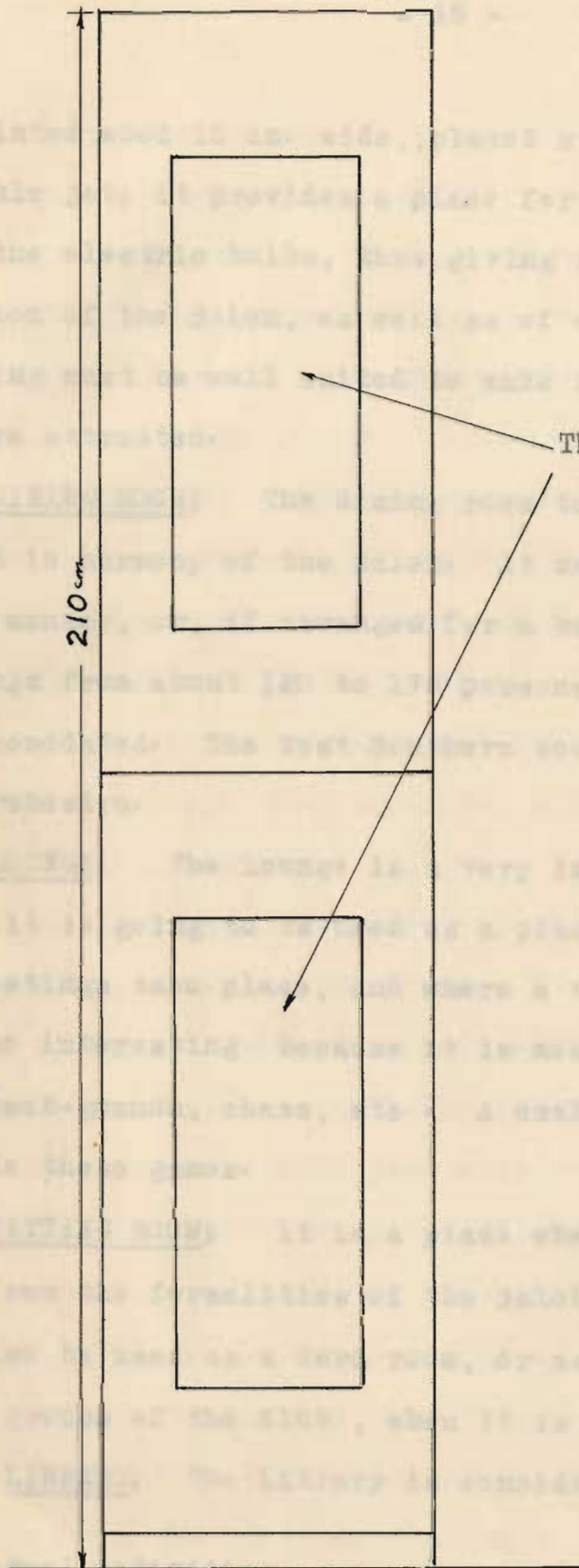

The Opening here may be either
mesh, louvres or perforation.

A Locker Plan and View or

Fig. 5 Elevation.

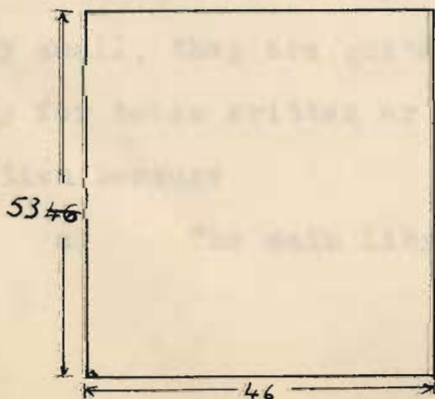

Scale 1-10

20-5-46

Mahmud Hallel

of painted wood 15 cm. wide, placed at 240cm. above the floor, will do a double job; it provides a place for hanging the pictures and for hiding the electric bulbs, thus giving indirect light. The interior decoration of the Salon, as well as of all the other main parts of the building must be well suited to make it a first class place where people are attracted.

DINING ROOM; The dining room too must be well decorated and furnished in harmony of the Salon. It can hold about 50 persons in an ample manner, or, if arranged for a banquet and U shaped table used, it can hold from about 120 to 175 persons. For a buffet froid 200-250 could be accomodated. The West Southern corner of the Salon is provided for the Orchestra.

LOUNGE; The Lounge is a very important part of the building, because it is going to be used as a place where informai gatherings and meetings take place, and where a visitor can wait for a member. It is also interesting because it is meant to be a place where one can play back-gommon, chess, etc.. A small office under the stairs will provide these games.

SITTING ROOM; It is a place where the member can have some rest away from the formalities of the Salon and the noise of the Lounge. It can also be used as a card room, or as a meeting place for the discussion groups of the Club, when it is needed.

LIBRARY; The Library is considered to be the nucleus of the intellectual activities of the Club. Although the dimensions are comparatively small, they are quite sufficient because the Library is devoted only for books written or published by Alumni. I have made this restriction because

- a) The main Library of College Hall is opened to the Alumni,

b) If it were to contain a great N° of books and be considered as a main Library, it should have a separate building, a building by itself to satisfy the requirements.

BAR; The Bar is situated on the south western part of the building. It is accessible from all parts of the Club and ,especially from the open Tennis Courts. A stair way can lead directly from the outside to the bar, without passing through the building. It is provided with a big terrace half covered by a balcony. From this terrace one can watch either the Tennis games in the open courts, or, the football matches on the A.U.B. football field. Also it has a very nice sight: the sea, A.U.B. grounds and buildings, Sannin and some small mountains on which are scattered villages with red roofs in the middle of a green environment.

Just in front of this Bar, there is a little lawn which can be used as an auxiliary bar during Spring, Summer and Autumn.

BED ROOMS; The bed rooms are divided into two categories, private rooms and appartments. The private rooms has a private bath and can contain two beds when need arises.

The appartment is composed of two sleeping rooms with a private bath; each room can hold two beds very easily.

BADMINTON; The Badminton court was chosen to be on the second floor because it requires a big hight which cannot be provided in the first or ground floor. In order to have the least noise and vibrations possible from the court to the whole building, a thick layer of sand is laid under the floor.

CARD ROOMS; The first and second storeys have a card room each which can hold 4 tables in an ample manner or 6 tables tightly.

When a big Tournament is held, the Lounge can be used, thus saving the trouble of having the tournament on two different floors. The lounge with the contiguous card room can accommodate easily 12 tables.

INFORMATION DESK; An Information desk is necessary for such a building. So the office on the main entrance is used as such.

Also phone communications between the different parts of the building add to the luxurious life and to the comfort of its members and visitors. So there must be a (centrale telephonique) under the staircase, leading to the first floor, behind the coat room. And switches and apparatus are provided wherever needed.

ARCHITECTURE

Now that we have finished the design part of the Club, let us come to the Architectural part of it.

Considering the main (northern) façade, one can see that it is exclusively modern;

a) The 12.3m. high 6 columns with the glass panes in between give an imposing effect to the Club.

b) Also the vertical stretched windows above the secondary circular entrance give a good modernistic contrast with the horizontal windows.

c) The recessed part on the first floor give such a good appearance that it is very appreciated in Modern Architecture. Also the difference of levels of the roof is what is required in modernistic ideas.

Anyway, the Façade as a whole is harmonious. The balcony on the first floor is not only to allow for the recess of the Tennis Court wall, but intended too, to have an open place for either evenings or small dancing parties.

Taking into consideration the East Façade, the lack of windows in the tennis court wall does not give a good effect; so a picture made out of mortar 2-2 1/2 (two to two and a half) cm. thick applied to the wall, and representing a man playing tennis, makes the façade look more beautiful and gives a very modernistic effect not only to the façade itself, but also to the all Club as a whole.

The contrast between windows vertically and horizontally stretched with the circular end of the building, has its share in making the Club look nicer from the West and from the A.U.B. football field.

Interior architecture; The interior decoration must be grandiose, especially for the main parts as Salon, Dining Room, Lounge and Library.

The Furniture must be luxurious and comfortable. As a whole, the place must be pleasant and inviting.

May I add some architectural fittings to the Lounge and Library. Directly below the windows, which are of the sliding type, small wall-closets are constructed as shown in fig. 6 (page 19). These could contain books, magazines, or news papers, and on their top flowers and green plant vases could be placed.

Light; As to the light, indirect electric lighting is used in all the building

Construction Materials; The building is of the framed structure type. It is as the other ordinary buildings except that the Façade is of tyrolien plaster (except the columns of the entrances, the recessed wall in between the windows and the eastern wall of the covered tennis court, which are covered with a simple smooth plaster). The building is paved with terrazo tiles, and 90cm. wide Arida stone is built at the periphery of the Salon and Dining Room.

SECTIONAL DRAWING

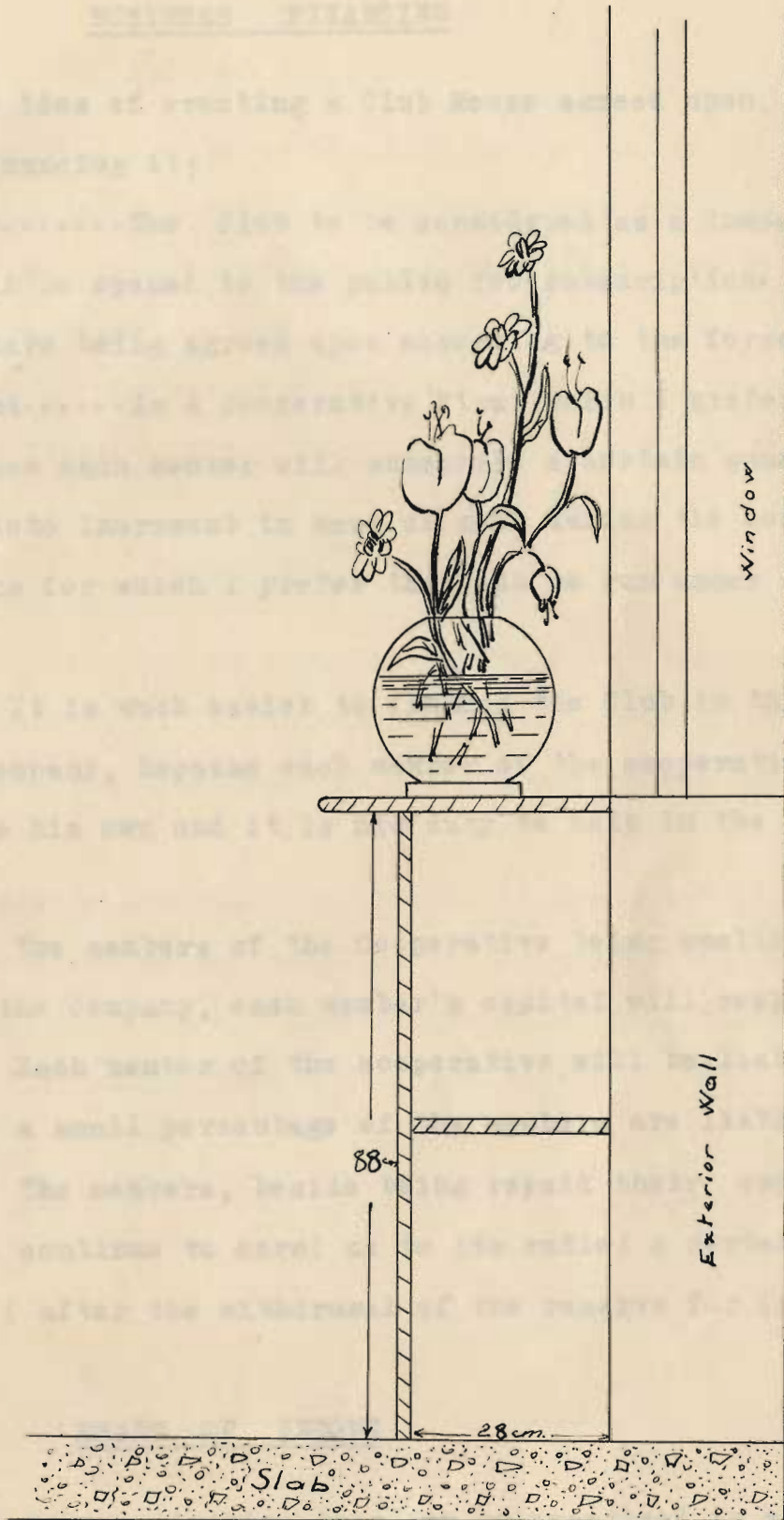

Section of Wall closet for Books

Fig. 6

Scale 1-10
20-5-46

Mahmud Hallob

BUSINESS FINANCING

Having the idea of erecting a Club House agreed upon, there are many ways of financing it:

First.....The Club to be considered as a Company. In this way, shares will be opened to the public for subscription. The face value of the share being agreed upon according to the foreseen income.

Second.....As a Cooperative Firm, which I prefer.

In this case each member will subscribe a certain sum of money as capital, reliable to increment in case of need during the construction.

The reasons for which I prefer the Club to run under a cooperative system are:

a) It is much easier to finance the Club in this way than if it were a company, because each member of the cooperative will feel that the Club is his own and it is his duty to help in the flourishing of it.

b) The members of the Cooperative being smaller in No in comparison to the Company, each member's capital will reap more profit.

c) Each member of the cooperative will be liable, while in a company only a small percentage of the members are liable.

d) The members, beside being repaid their capital in future years, it will continue to earn (as to its ratio) a certain percentage of the profit (after the withdrawal of the reserve for future contingencies.)

MEANS OF INCOME

There are many activities that can be practised in a club to reap income; such as : Bar, Tennis tournaments managed according to entrance fees, all kinds of games, social activities and Balls.

MANAGEMENT

The Club needs an efficient Board of Directors, if it is going to be a success. Usually the Board of Directors consists of a Director, a Manager, a Cashier, and honorable members elected from among the members, by the members.

The Manager has the responsibility of calling for members to form various sub-committees to meet the needs of the Club activities.

CONCLUSION

To conclude, the Club is a necessity both for the Alumni as well as for the Community. It builds men physically, morally, socially and politically fit to lead the country to its proper place in the civilized world.

Before I come to the end of my thesis, I feel much obliged to Professor Manasseh who helped me a lot in the conception of the plans. A word of thanks is due to Mr. Shehadi for submitting himself as a medium between the Alumni Tennis Club and myself.

..... I N D E X

	<u>Page N°</u>
Introduction	1
Location of Building	4
Main Idea	4
Requirements	4
Design	5
Fig. (1) (Section of Bowling Alley)	9
Fig. (2) (Noise preventive curtain wall)	10
Fig. (3) (Main Entrance Door)	11
Fig. (4) (Iron folding gate)12	12
Fig. (5) (A Locker)	14
Architecture	17
Lighting	18
Construction Materials	18
Fig. (6) (Section of Lounge wall closet)	19
Business Financing	20
Means of Income	20
Management	21
Conclusion	22

.....

..... P L A T E S

	<u>Plate N°</u>
Location Plan	1
Basement Plan	2
Ground Floor Plan	3
First Floor Plan	4
Second Floor Plan	5
East and West Elevations	6
North Elevation	7
Three Cross Sections	8
Longitudinal Section	9

